

floor tiling



Floor Tile Adhesive Selector

	CEMENTITIOUS					FLEXIBLE CEMENTITIOUS						2 PART
	gold star	ctf3	rapidset	supercover rapidset	pourable thick bed	mosaic-fix	green screed	single part flexible	rapidset flexible	ptb flexible	acousti-bond	
APPLICATION AREA												
Interior, Dry	■	■	■	■	■	■	■	■	■	■	■	■
Exterior	■	■	■	■	■	■	■	■	■	■	■	■
INSTALLATION												
Bathroom, Intermittent Wetting	■	■	■	■	■	■	■	■	■	■	■	■
Domestic Shower	■	■	■	■	■	■	■	■	■	■	■	■
Communal Shower	■	■	■	■	■	■	■	■	■	■	■	■
Swimming Pool	■	■	■	■	■	■	■	■	■	■	■	■
Minor Vibration Heavy Trafficking	■ A	■ A	■ A	■ A	■ A	■	■	■	■	■	■	■
Limited Deflection	■	■	■	■	■	■	■	■	■	■	■	■
BASES												
Plywood Overlaid Floors	■ A	■ A	■ A	■ A	■ A	■	■	■	■	■	■	■
Suspended Concrete Floor	■ A	■ A	■ A	■ A	■ A	■	■	■	■	■	■	■
Tongue & Groove Floorboards	■	■	■	■	■	■	■	■	■	■	■	■
Cement-Sand Screed Mastic Asphalt	■	■	■	■	■	■	■	■	■	■	■	■
Anhydrite Screed	■ P	■ P	■ P	■ P	■ P	■ P	■ P	■ P	■ P	■ P	■ P	■ P
Heated Screeds	■ A	■ A	■ A	■ A	■ A	■	■	■	■	■	■	■
Vinyl Tiles/Sheets	■ A or B	■ A or B	■ A or B	■ A or B	■ A or B	■	■	■	■	■	■	■
Unglazed Ceramic Tiles	■	■	■	■	■	■	■	■	■	■	■	■
Hard Natural Stone	■	■	■	■	■	■	■	■	■	■	■	■
Glazed Ceramic Tiles	■ A	■ A	■ A	■ A	■ A	■	■	■	■	■	■	■
Steel	■	■	■	■	■	■	■	■	■	■	■	■
Epoxy Paint	■ A	■ A	■ A	■ A	■ A	■ SS	■ SS	■ SS	■ SS	■ SS	■ SS	■ SS

TONGUE & GROOVE FLOORBOARDS



CERAMIC/QUARRY TILE/TERRAZZO/HARD NATURAL STONE BASES



VINYL TILE/SHEET BASES

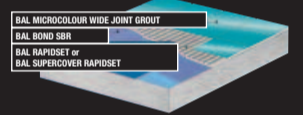

TILING TO HEATED SCREEDS

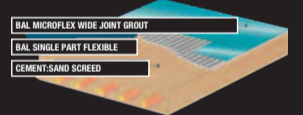

TILING TO IMPACT SOUND DEADENING INSULATION

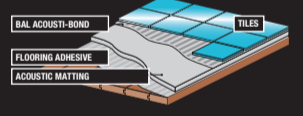

Floor Tile Grout Selector

	CEMENTITIOUS		PRO-HYGIENE SYSTEMS		EPOXY-RESIN		
	wide joint	superflex WIDE JOINT	microflex WIDE JOINT	microcolour WIDE JOINT	easypoxy	floor epoxy	epoxy lv
APPLICATION AREA							
Interior	■	■	■	■	■	■	■
Exterior	■	■	■	■	■	■	■
INSTALLATION							
Bathroom, Intermittent Wetting	■	■	■	■	■	■	■
Domestic Shower	■	■	■	■	■	■	■
Communal Shower	■	■	■	■	■	■	■
Swimming Pool	■	■	■	■	■	■	■
Floating Wooden Floors	■ A	■	■	■	■	■	■
SPECIAL REQUIREMENTS							
Antibacterial	■	■	■	■	■	■	■
Hygienic, Sterile Conditions For Food Use	■	■	■	■	■	■	■
Chemical Resistance	■	■	■	■	■	■	■
Minor Vibration Limited Deflection	■ A	■	■	■	■	■	■
Moderate Trafficking	■	■	■	■	■	■	■
Heavy Trafficking	■ A	■	■	■	■	■	■

GLASS REINFORCED POLYESTER (GRP) BACKGROUNDS/BASES



STEEL BACKGROUNDS/BASES

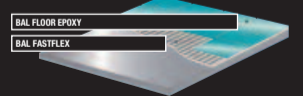

KEY
 A = Admixture
 B = BAL Bond SBR
 P = Primer
 SS = Score Surface

For complete information on the background preparation and application of these products, refer to the Technical Data Sheets or call the BAL Technical Advisory Service on 0845-600-1-222

Note: The customer must verify the suitability of any information, opinion, recommendation or advice ("Information") provided by the Company for the particular application for which any goods are intended to be used and the Company accepts no liability (whether in contract, tort or otherwise) whatsoever for any loss, damage or expense arising from the misuse of any information it supplies nor for the use of any information in or for applications which are unsuitable or inappropriate. Building Adhesives Ltd operates a continuous research and development programme and reserves the right to alter or to update information from time to time.

wall tiling



Wall Tile Adhesive Selector

	READY MIXED				CEMENTITIOUS			FLEXIBLE CEMENTITIOUS			2 PART
	green star	blue star	white star	tile & grout	ctf3	rapidset	supercovers rapidset	mosaic-fix	single part flexible	rapidset flexible	flex
APPLICATION AREA											
Interior, Dry	■	■	■	■	■	■	■	■	■	■	■
Exterior	-	-	-	-	■	■	■	■	■	■	■
INSTALLATION											
Bathroom, Intermittent Wetting	■	■	■	■	■	■	■	■	■	■	■
Domestic Shower	-	-	-	-	■	■	■	■	■	■	■
Communal Shower	-	-	-	-	■	■	■	■	■	■	■
Swimming Pool	-	-	-	-	■	■	-	■	■	■	■
Minor Vibration	-	-	-	■	■ A	■ A	■ A	■	■	■	■
Limited Deflection	-	-	-	-	-	-	-	-	-	-	■
BACKGROUNDS											
Cement: Sand Rendering	■	■	■	■	■	■	■	■	■	■	■
Standard Brick/Block	-	-	-	-	■ A	■ A	■ A	■	■	■	■
Dense Brick/Block/Concrete	-	-	-	-	■ AP	■ AP	■ AP	■	■	■	■
Lightweight Blockwork	-	-	-	-	■ AP	■ AP	■ AP	■ P	■ P	■ P	■
Plaster	■	■	■	■	■ P	■ P	■ P	■ P	■ P	■ P	■
Plasterboard	■	■	■	■	■ AP	■ AP	■ AP	■ P	■ P	■ P	■
Tile Backer Boards	■	■	■	■	■ A	■ A	■ A	■	■	■	■
Fibre Cement Sheets	■	■	■	■	■ A	■ A	■ A	■	■	■	■
MDF Board	-	-	-	-	-	-	-	■	■	■	■
Unglazed Ceramic Tiles	■	■	■	■	■	■	■	■	■	■	■
Hard Natural Stone	■	■	■	■	■	■	■	■	■	■	■
Plywood Walls	■	■	■	■	■ A	■ A	■ A	■	-	-	■
Painted Walls	■	■	■	■	■ A	■ A	■ A	■	-	-	■
Glazed Ceramic Tiles	■	■	■	■	■ A	■ A	■ A	■	-	-	■
Steel	-	-	-	-	-	-	-	■	■	■	■

GLAZED TILES/BRICKS

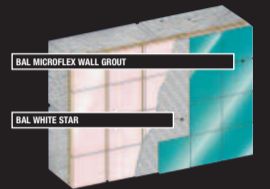

FIBRE REINFORCED CEMENT SHEETS

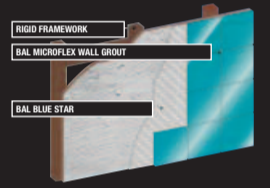

FIBRE MESH REINFORCED CEMENT FACED TILE BACKER BOARDS

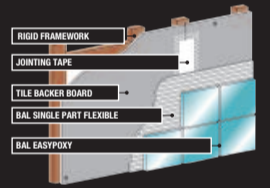

PLYWOOD/CHIPBOARD CALCIUM SILICATE BOARDS

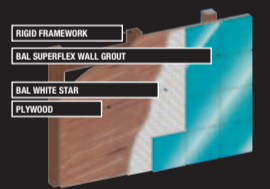

GYPSUM PLASTER

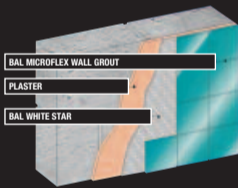

GYPSUM PLASTERBOARD

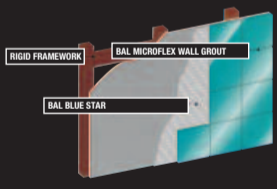

CEMENT:SAND RENDERING

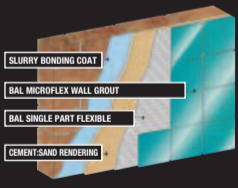

LIGHTWEIGHT BLOCK WALLING

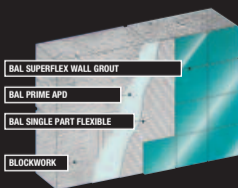

DENSE CONCRETE/BLOCK WALLING

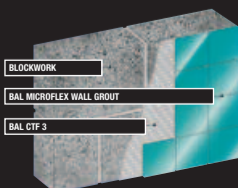

Wall Tile Grout Selector

	READY MIXED	CEMENTITIOUS		PRO-HYGIENE SYSTEMS		EPOXY-RESIN
	supergrout	bal grout	superflex	microflex	microcolour	easypoxy
APPLICATION AREA						
Interior, Dry	■	■	■	■	■	■
Exterior	-	■	■	■	■	■
INSTALLATION						
Bathroom, Intermittent Wetting	■	■	■	■	■	■
Domestic Shower	-	■	■	■	■	■
Communal Shower	-	■	■	■	■	■
Swimming Pool	-	■	■	■	■	■
Worktop	-	-	-	-	-	■
SPECIAL REQUIREMENTS						
Antibacterial	-	-	-	■	■	-
Hygienic, Sterile Conditions For Food Use	-	-	-	-	-	■
Chemical Resistance	-	-	-	-	-	■
Minor Vibration Limited Deflection	■	■ A	■	■	■	■

PAINTED WALLS

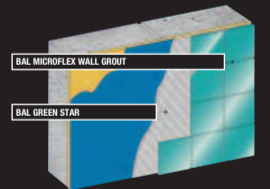

KEY
A = Admixture
P = Primer

For complete information on the background preparation and application of these products, refer to the Technical Data Sheets or call the BAL Technical Advisory Service on 0845-600-1-222

Note: The customer must verify the suitability of any information, opinion, recommendation or advice ("information") provided by the Company for the particular application for which any goods are intended to be used and the Company accepts no liability (whether in contract, tort or otherwise) whatsoever for any loss, damage or expense arising from the misuse of any information it supplies nor for the use of any information in or for applications which are unsuitable or inappropriate. Building Adhesives Ltd operates a continuous research and development programme and reserves the right to alter or to update information from time to time.